



EXISTING

ARCHITECT

INTEGRATED
DESIGN
GROUP

© Integrated Design Group Pty Ltd
ABN 64 115 006 320
Nominated Architect
Simon Thorne reg. no. 7093
info@idgarchitects.com.au
www.idgarchitects.com.au

NOTES

- Figured dimensions take precedence over scaled drawings
- Contractors to check and verify all levels datum and dimensions on site
- All materials and workmanship to be in accordance with current written manufacturers instructions, local regulations and SAA codes
- Conflicting information to be brought to notice of the architect and clarification sought before proceeding with any works
- All drawings are not for construction and are subject to further design development, consultant input, council and legislative requirements.
- Refer to General notes page for legend and abbreviations

DISCIPLINES

Access
Acoustic
Arboret
BCA
Landscape
Planner
Surveyor
Traffic
Waste

#Access
#Acoustic
#Arboret
#BCA
#Landscape Consultant
#Planning Consultant
#Surveyor
#Traffic
#Waste

Civil
Electrical
Geotech
Hydraulic
Mechanical
Structure
PCA
Builder

#Civil Engineer
#Services Consultant
#Geotech
#Hydraulic Engineer
#Mechanical Engineer
#Structural Engineer
#Certifier
#Builder

CLIENT

KATRINA LEE

2 ALLIBONE STREET ASHBURY

PROJECT

Alterations and additions

SITE: 2 Allibone Street Ashbury NSW 2193
REF: ASH21072

REVISION

11/5/2022	A	ISSUE FOR REVIEW
11/5/2022	B	ISSUE FOR REVIEW
17/5/2022	C	ISSUE FOR REVIEW
30/11/2022	D	ISSUE FOR HERITAGE REVIEW
24/5/2023	E	DESIGN COORDINATION

DRAWING

GROUND FLOOR PLAN

DRAWING

DA-1100

ISSUE

E

DRAWN

CHECKED

SCALE

IDG CHECKED

1:100 @ #2

KJ

#2

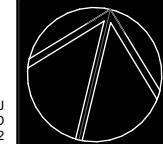

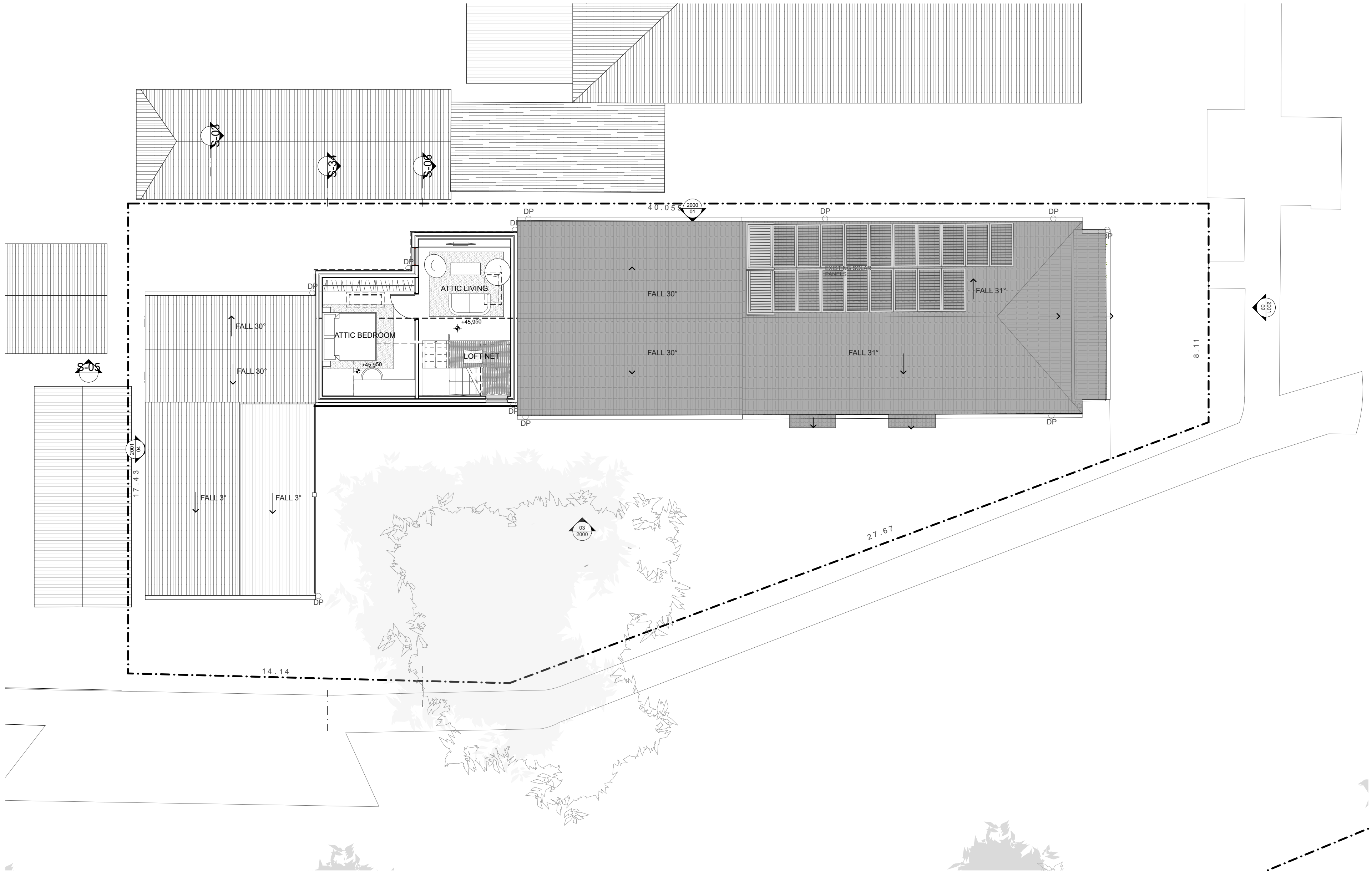

EXISTING

ARCHITECT

INTEGRATED
DESIGN
GROUP

© Integrated Design Group Pty Ltd
ABN 64 115 006 329
Nominated Architect
Simon Thorne reg. no. 7093
info@idgarchitects.com.au
www.idgarchitects.com.au

NOTES

1. Figured dimensions take precedence over scaled drawings
2. Contractors to check and verify all levels datum and dimensions on site
3. All materials and workmanship to be in accordance with current written manufacturers instructions, local regulations and SAA codes
4. Conflicting information to be brought to notice of the architect and clarification sought before proceeding with any works
5. All drawings are not for construction and are subject to further design development, consultant input, council and legislative requirements.
6. Refer to General notes page for legend and abbreviations

DISCIPLINES

Access
Acoustic
Arboret
BCA
Landscape
Planner
Surveyor
Traffic
Waste

#Access
#Acoustic
#Arboret
#BCA
#Landscape Consultant
#Planning Consultant
#Surveyor
#Traffic
#Waste

Civil
Electrical
Geotech
Hydraulic
Mechanical
Structure
PCA
Builder

#Civil Engineer
#Services Consultant
#Geotech
#Hydraulic Engineer
#Mechanical Engineer
#Structural Engineer
#Certifier
#Builder

CLIENT

KATRINA LEE

2 ALLIBONE STREET ASHBURY

PROJECT

Alterations and additions

SITE: 2 Allibone Street Ashbury NSW 2193
REF: ASH21072

REVISION

REVISION	DATE	ISSUE FOR REVIEW
17/5/2022	A	ISSUE FOR REVIEW
30/11/2022	B	ISSUE FOR HERITAGE REVIEW
24/5/2023	C	DESIGN COORDINATION

DRAWING

FIRST FLOOR PLAN

DRAWING

DA-1101

ISSUE

C

DRAWN
CHECKED
SCALE

IDG CHECKED
1:100 @ #2

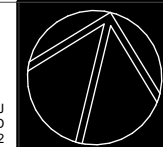

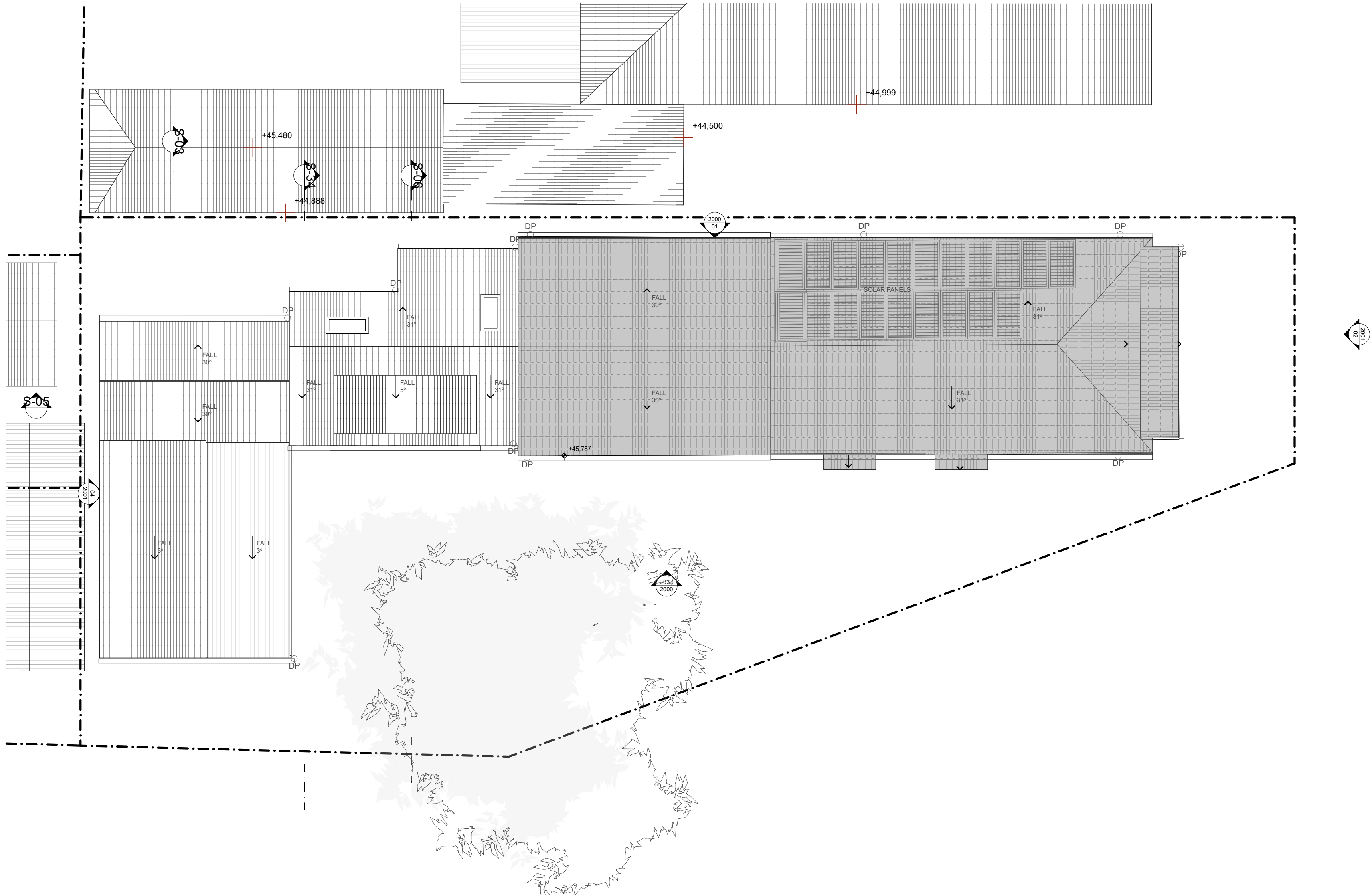

EXISTING

ARCHITECT

INTEGRATED
DESIGN
GROUP

© Integrated Design Group Pty Ltd
ABN 64 115 086 329
Nominated Architect
Simon Thorne reg. no. 7093
info@idgarchitects.com.au
www.idgarchitects.com.au

NOTES

- Figured dimensions take precedence over scaled drawings
- Contractors to check and verify all levels datum and dimensions on site
- All materials and workmanship to be in accordance with current written manufacturers instructions, local regulations and SAA codes
- Conflicting information to be brought to notice of the architect and clarification sought before proceeding with any works
- All drawings are not for construction and are subject to further design development, consultant input, council and legislative requirements.
- Refer to General notes page for legend and abbreviations

DISCIPLINES

Access
Acoustic
Arborist
BCA
Landscape
Planner
Surveyor
Traffic
Waste

#Access
#Acoustic
#Arborist
#BCA
#Landscape Consultant
#Planning Consultant
#Surveyor
#Traffic
#Waste

Civil
Electrical
Geotech
Hydraulic
Mechanical
Structure
PCA
Builder

#Civil Engineer
#Services Consultant
#Geotech
#Hydraulic Engineer
#Mechanical Engineer
#Structural Engineer
#Certifier
#Builder

CLIENT

KATRINA LEE

2 ALLIBONE STREET ASHBURY

PROJECT

Alterations and additions

SITE: 2 Allibone Street Ashbury NSW 2193
REF: ASH21072

REVISION

17/5/2022	A	ISSUE FOR REVIEW
30/11/2022	B	ISSUE FOR HERITAGE REVIEW
2		
24/5/2023	C	DESIGN COORDINATION

DRAWING

ROOF PLAN

DRAWING

DA-1102

ISSUE

C

DRAWN

CHECKED

SCALE

IDG CHECKED

1:100 @ #2

